

GHISAMESTIERI  
BERTINORO - ITALY

Certification:  
UNI EN ISO 9001:2000



EN 40-5:2002  
Street Lighting steel poles  
for circulation areas

TECHNICAL CARD OF SPECIFICATIONS - SCALA 1:25 - REV.01 - OCTOBER 2008

MELDANS P02 VER 7 M

Lighting Pole in hot galvanized steel in conformity with UNI ISO 1461:1999 and composed of:

1) **Steel pole with round section, hot galvanized in according to UNI ISO 1461:1999 and composed of 2 pipes  $\varnothing 152 \times 1200$ mm (A) and  $\varnothing 102 \times 3642$  (B) curved and modeled as the drawing shows.** Furthermore the pole is endowed of a screw M12 (heating clamp), of a squared slot  $500 \times 120$  placed at 1000mm from the ground level. On the slot's cover door there are some small squared slots  $90 \times 15$ mm that are lighted with fluoeshent lamps. In the inner part of the tube  $\varnothing 152$ , close to the slot, a plate for the fixing of junction box is welded.

2) **A bracket with a pipe of  $\varnothing 33$  (C) welded in the upper part and modeled.** The pipe (C) is closed in its extremity from a steel bottom and is endowed of a hole for the cables passage, placed in the centre of the streight part.

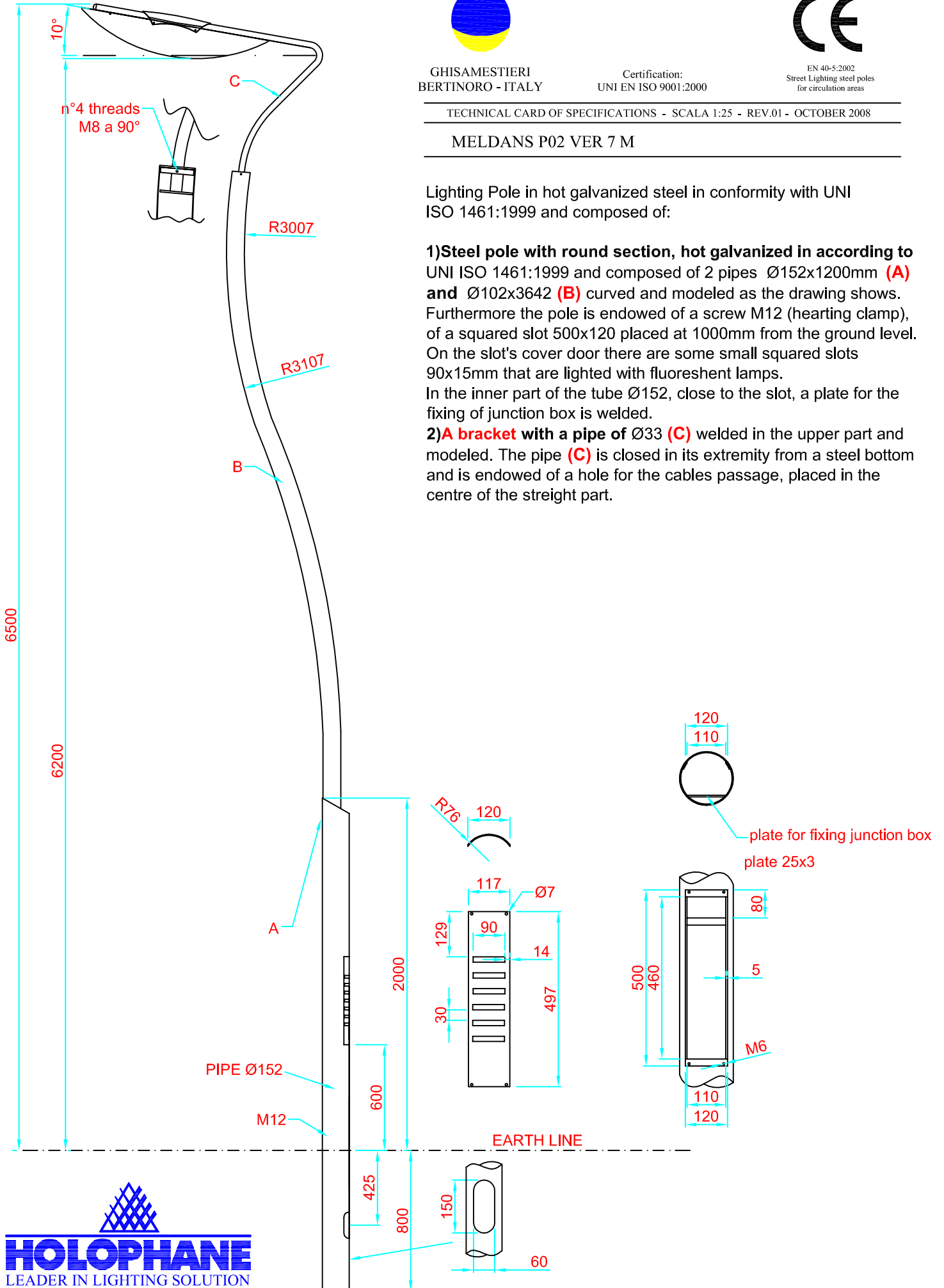

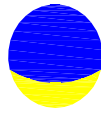

GHISAMESTIERI  
BERTINORO - ITALY

CERTIFICATIONS:  
UNI EN ISO 9001:2000



EN 40-5:2002  
Street Lighting steel poles for  
circulation areas

TECHNICAL CARD OF SPECIFICATIONS - SCALA 1:25 - REV.01 - OCTOBER 2008

### MELDANS P02\_ STANDARD

Lighting Pole in hot galvanized steel in conformity with UNI ISO 1461:1999 and composed of:

**1) Steel pole with round section, hot galvanized in according to UNI ISO 1461:1999 and composed of 2 pipes  $\varnothing 152 \times 1200$ mm (A) and  $\varnothing 102 \times 3491$  (B) curved and modeled as the drawing shows. Furthermore the pole is endowed of a screw M12 (heating clamp), of a squared slot  $500 \times 120$  placed at  $1000$ mm from the ground level. On the slot's cover door there are some small squared slots  $90 \times 15$ mm that are lighted with fluoeshent lamps. In the inner part of the tube  $\varnothing 152$ , close to the slot, a plate for the fixing of junction box is welded.**

**2) A bracket with a pipe of  $\varnothing 33$  (C) welded in the upper part and modeled. The pipe (C) is closed in its extremity from a steel bottom and is endowed of a hole for the cables passage, placed in the centre of the streight part.**

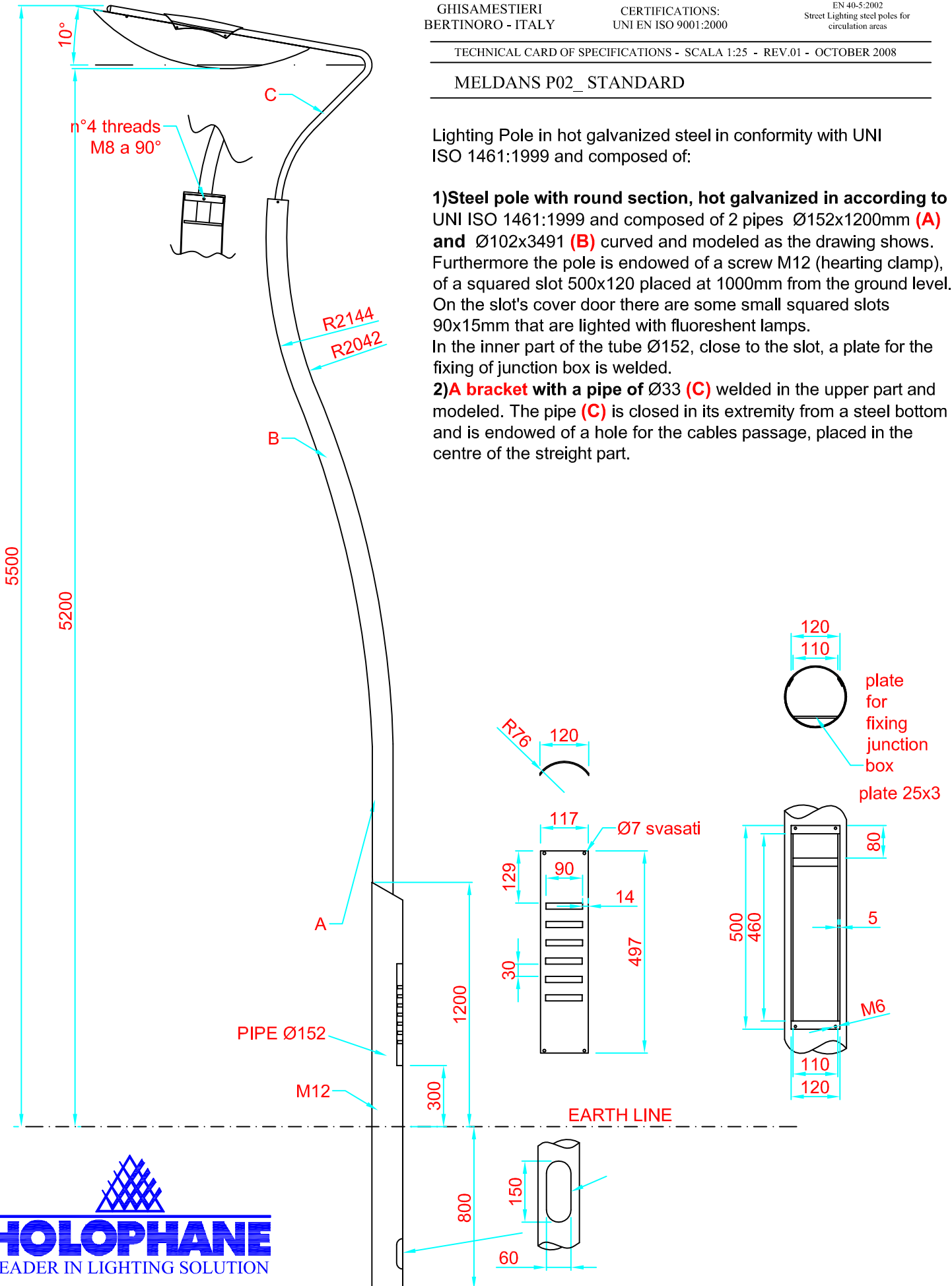

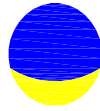

GHISAMESTIERI  
BERTINORO - ITALY

Certification:  
UNI EN ISO 9001:2000



EN 40-5:2002  
Street lighting steel poles  
for circulation areas

TECHNICAL CARD SPECIFICATIONS - SCALA 1:25 - REV.01 - OCTOBER 2008

MELDANS P02 DOUBLE VER\_2M\_7m

Lighting Pole in hot galvanized steel in conformity with UNI ISO 1461:1999 and composed of:

**1) Steel pole with round section, hot galvanized in according to UNI ISO 1461:1999 and composed of 2 pipes  $\varnothing 152 \times 2000$ mm (A) and  $\varnothing 102 \times 3642$  (B) curved and modeled as the drawing shows. Furthermore the pole is endowed of a screw M12 (heating clamp), of a squared slot  $500 \times 120$  placed at 600mm from the ground level. On the slot's cover door there are some small squared slots  $90 \times 15$ mm that are lighted with fluoreshent lamps. In the inner part of the tube  $\varnothing 152$ , close to the slot, a plate for the fixing of junction box is welded.**

**2) Two brackets with a pipe of  $\varnothing 33$  (C) welded in the upper part and modeled. The pipe (C) is closed in its extremity from a steel bottom and is endowed of a hole for the cables passage, placed in the centre of the streight part.**

