

module™ 600

applications

- Tunnels
- Security lighting
- Precincts
- Car parks
- Transport depots
- External areas
- Stockyards
- Stations

For areas where conventional floodlights would be deemed visually unsuitable, Module™ 600 offers a highly effective solution with outstanding performance. The specially engineered glass optical system achieves maximum energy efficiency without sacrificing performance and minimising glare. The prismatic glass refractor directs light in an asymmetric distribution both downwards and sideways to enable a space-to-height ratio of 6:1, whilst still providing superb uniformity. To reduce light pollution, an optional external top visor can be fitted to the luminaire, thus significantly reducing upward light from the luminaire.



features and benefits

Architectural design

- > Fits in with a multitude of surroundings

Rugged construction

- > Durability
- > Vandal resistant

Superb uniformity

- > No dark areas
- > Improved safety

Wide spacings

- > Reduced number of luminaires

Optional top visor

- > Reduces light pollution

lamp types included

250W - 400W metal halide (various)

150W - 400W high pressure sodium

IP rating

IP54 

approvals

Complies with EN60598

CE



specification

The luminaire shall consist of a single piece die-cast aluminium body, housing all integral control gear to suit a wide choice of high intensity discharge lamps. The optical assembly shall consist of a specular aluminium reflector and a moulded prismatic borosilicate glass refractor. The refractor shall be sealed within the front door assembly and shall be attached to the back casting by two concealed hinges with a single positive action latch at the top. The two sections shall be sealed by a closed cell resilient gasket ensuring an IP rating of 54. The luminaire shall be suitable for either wall or pole mount and shall comply with EN60598 with a wide choice of options and accessories.

light distribution

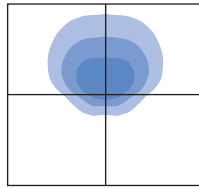

Photometric data is available at www.holophane.eu.com

windage

Code

Module 600	0.169m ²
------------	---------------------

weights & thermal data

Lamp Type	Weight (kg)	Min Operating Temperature (°C)	Max Ambient Temperature (°C)*	
			Vertical	Horizontal
150W High Pressure Sodium	20	-30	45	35
250W High Pressure Sodium	21	-30	45	35
400W High Pressure Sodium	22	-30	35	25
250W Metal Halide	21	-20	45	35
400W Metal Halide	22	-20	35	25

* The maximum ambient temperatures stated are for exterior use only. For interior use deduct 10°C from the max temperature stated.

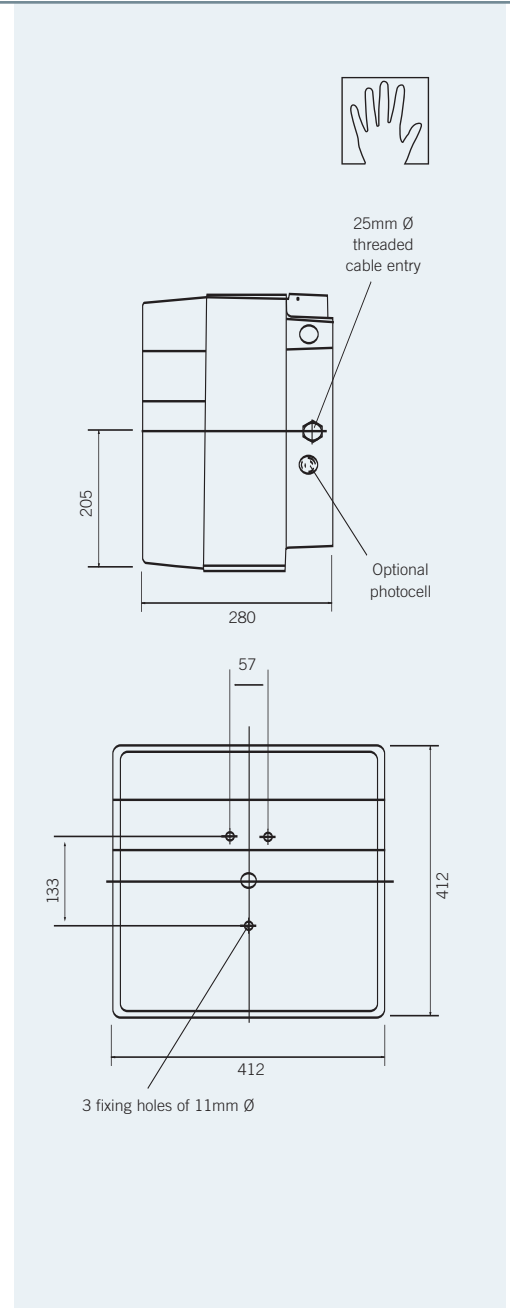

ordering details : luminaire

Code

NMOD Module 600

Code	Lamp Type
.150XT	150W Clear High Output HPS Lamp (E40) Base
.250XT	250W Clear High Output HPS Lamp (E40) Base
.400XT	400W Clear High Output HPS Lamp (E40) Base
.250H DP	250W Coated 5000K Protected Metal Halide Lamp (E40) Base
.400H DP	400W Coated 5000K Protected Metal Halide Lamp (E40) Base

Code	Colour
.C1	White (RAL 9016)
.C4	Graphite (RAL 7011)
.C6	Grey (RAL 7035)
.C7	Black (RAL 9005)
.C9	Metallic Silver (RAL 9006)
.RAL****	RAL colour (customer choice)***

Code	Options
.C	Enhanced Paint Finish
.M	Electronic Relay Circuit**†
.T	Photocell (Factory Fitted)*†

Example

NMOD .150XT .C9 .C

** Not available with instant restrike lamps.† .M and .T not available together.***Please specify RAL colour reference. Note: Other voltages available on request. Timed ignitors available on request.

luminaire accessories

order separately for on site installation by others

Code

MOD.S1	Internal Side Shield (maximum of 3 per Luminaire)
MOD.V1	Polycarbonate External Shield
MOD.V2	External Top Visor
MOD.TC70	Photocell & Fixing Kit (Retro-Fit)

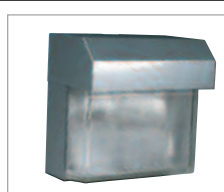

MOD.V2 - Top Visor